



TRIPLOG

User manual for

# Triplog<sup>®</sup> AlcoTrue

Alcometer, Breathalyzer





## Introduction

Thank you for purchasing Triplog AlcoTrue® alcometer from Opus Prodox AB. Triplog AlcoTrue® uses the same technology as used by the police in their alcometers. Therefore you can be sure of that you get a correct result when you use Triplog AlcoTrue®. Triplog AlcoTrue® is easy to use and you get the test results quickly.

## Liability

With Triplog AlcoTrue® you can check that you do not have any alcohol in your body before you drive your car.

*Never drive influenced by alcohol!*

If you are not 100% sure, do not drive!!

AlcoTrue® is a pre-test device. Absolutely accurate results of blood alcohol concentration can only be obtained by blood alcohol analysis. Opus Prodox does not have any legal responsibility for AlcoTrue® measurement results.

## Before you use Triplog AlcoTrue®

AlcoTrue® comes with 3 batteries and 3 mouthpieces. Open the battery cover and insert the batteries.

Use only mouthpieces from Opus or Opus retailers. After a test you should change mouthpiece for correct result!

Note! If you need to change batteries, change all 3 at the same time!

## Important...

- Wait at least 20 minutes after you have consumed alcohol before making a breath test using AlcoTrue®.

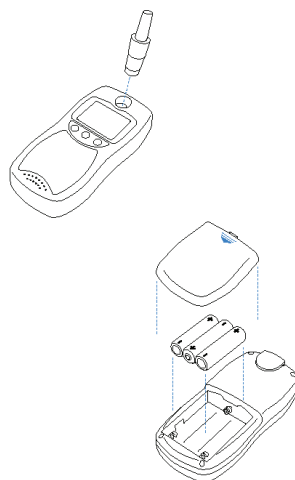



This is to make sure that you do not have any alcohol in your mouth which might interfere with the measurements and also that all consumed alcohol has reached the blood.

- If you smoke, please wait at least 3 minutes after smoking before making a breath test. Smoke in the exhaled air may cause incorrect results and may damage the alcohol sensor.
- AlcoTrue® has to be calibrated every 12 months to secure correct function. AlcoTrue® will automatically inform you in advance when it is time for calibration.
- To get as accurate result as possible the breath test should be done at room temperature. AlcoTrue® should be stored in room temperature at least 30 minutes before use.
- Use only original mouthpieces from Opus.
- AlcoTrue® is a pre-test device. Absolutely accurate results of blood alcohol concentration can only be obtained by blood alcohol analysis

## How to use Triplog AlcoTrue®

### Breath test

Put a mouthpiece into the hole in the front of AlcoTrue®. Press the On/Off key (middle key) until a beep is heard. When switched on AlcoTrue® will perform a self test and indicate until when it is calibrated.



When the display shows "Ready for test - Blow until beep stops" take a deep breath and blow until the beep stops. AlcoTrue® will now analyze the result.

After a few seconds (depending on the alcohol level) the result will be displayed.

The last 20 results are stored in the memory.

By pressing and holding the On/Off key for 3 seconds AlcoTrue® is turned off. It is also automatically turned off after 2 minutes.



## Display results

Press the On/Off key until you hear a beep.

When the display shows "Ready for test - Blow until beep stops" press the On/Off key you are now at the main menu

Press the arrow key to "Results"

Press OK

The last result is displayed.

By pressing the arrow keys you can see the last 20 results

Press the On/Off key and you are back in the main menu

## Turn off



You can always turn off Triplog AlcoTrue® by pressing and hold the On/Off key for 3 seconds.

Triplog AlcoTrue® automatically be turned off after 2 minutes.



## Setup

Press the On/Off key until a beep is heard.  
When the display show "Ready for test - Blow until beep stops"  
press the On/Off key you are now at the main menu  
Press the arrow key to "Setup"

### Select language

Press the arrow key to "Language"  
Press OK  
Press the arrow key to desired language  
Press OK  
you have now set the language.

### Change display brightness

Press the arrow key to "Brightness". Press OK.  
Press the arrow keys to desired level of brightness of the display. Press OK.  
You have now set the brightness of the display

### Adjust the time

Press the arrow key to "Clock"  
Press OK  
Press the arrow keys to set hour  
Press OK  
Press the arrow keys to set minute  
Press OK  
You have now set the time





# TRIPLOG

---

## Adjust the sound volume

Press the arrow key to "Sound"

Press OK

Press the arrow keys to select on or off

Press OK

you have now set the sound volume.

Note! If you have turned off the sound signal you must blow until you hear a click in Triplog AlcoTrue®

## Description of display symbols

### Battery symbol

The battery symbol shows the remaining battery capacity.

4 green lines: 100%

3 green lines: 75%

2 green lines: 50%

1 yellow line: 25%

Red symbol: <25%

Note! If you need to change batteries, change all 3 at the same time!

### Temperature symbol

The temperature symbol indicates if AlcoTrue® is too hot or too cold to be used.

Red temperature symbol: Temperature > 65 °C

AlcoTrue® C must be cooled down to room temperature before it can be used.

Blue temperature symbol: Temperature < -5 °C

AlcoTrue® must be warmed up to room temperature before use



## Error messages

Error message	Action
Error! Self test failed! Please contact service!	AlcoTrue® needs service or repair. (Please refer to the last page for service information.)
Please contact service for calibration	AlcoTrue® needs calibration. (Please refer to the last page for service information.)
Calibration outdated	AlcoTrue® requires calibration immediately. (Please refer to the last page for service information.) AlcoTrue® will function after a delay of 10 seconds. However the test results may not be accurate!
Not calibrated and/or Bad temperature	Result is displayed but may not be accurate because it is not calibrated and/or the temperature is too low or too high.
Test failure Please redo test	Please repeat the breath test. You may not have blown long enough to get an accurate result.
Warning! Temperature too high Cool down the device	Cool down AlcoTrue® to room temperature.
Warning! Temperature too low Heat up the device	Warm up AlcoTrue® to room temperature.
Low battery Shutting down	Change batteries. AlcoTrue® is automatically switched off.



## Calibration and service

Triplog AlcoTrue® must be calibrated every 12 months in order to secure accurate results.. Triplog AlcoTrue® will automatically inform you when it is time for calibration.

Contact your retailer for information of where you can calibrate your instrument. For other service places, check our homepage [www.triplog.se](http://www.triplog.se)

You can also contact Opus Prodox at

+46 31 748 34 00

## Expendables

Mouthpieces:

Bag 25 pcs

Bag 250 pcs

Fuel cell:

The fuel cell, i.e.the sensor that measures the alcohol must normally be replaced every 24 months to ensure correct results. The fuel cell is replaced when the instrument is calibrated if needed.

Opus Prodox AB, Bäckstensgatan 11C, 431 49 Mölndal,Sweden

[www.triplog.se](http://www.triplog.se)